

F  
E  
D  
C  
B  
A

F  
E  
D  
C  
B  
A

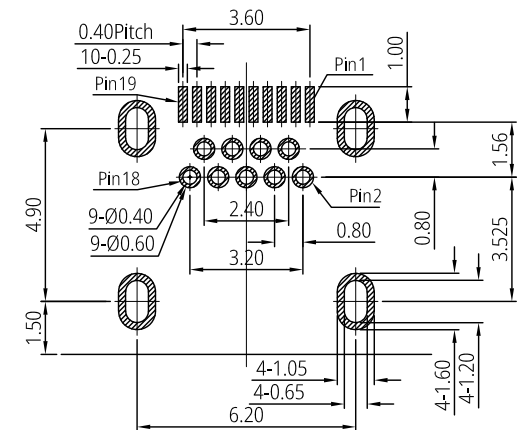
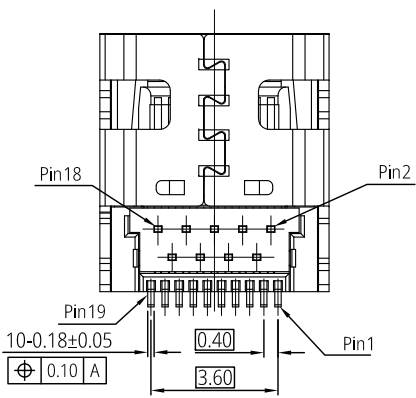
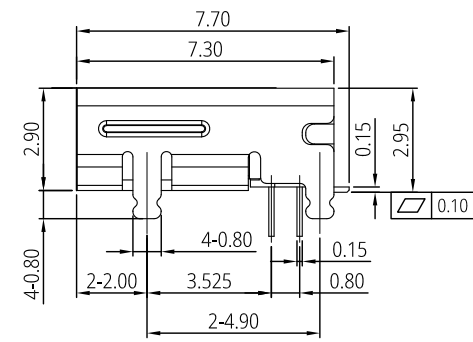
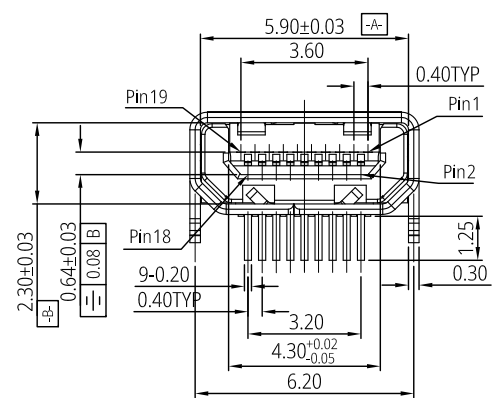
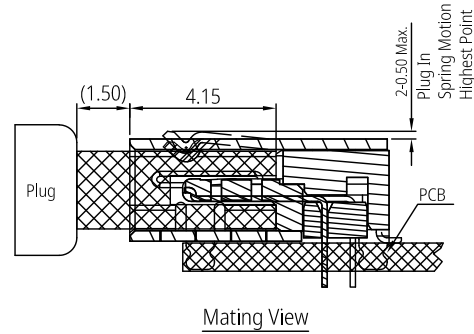
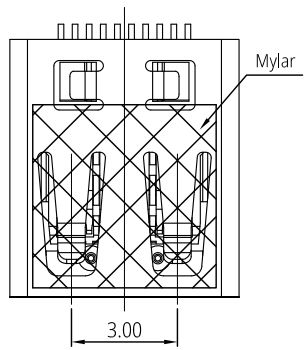

Recommended P.C.B Layout (Top View)  
Thickness: 0.80±0.05mm

Pin	Signal Assignment
1	Hot Plug Detect
2	Utility
3	TMDS Data2+
4	TMDS Data2 Shield
5	TMDS Data2-
6	TMDS Data1+
7	TMDS Data1 Shield
8	TMDS Data1-
9	TMDS Data0+
10	TMDS Data0 Shield
11	TMDS Data0-
12	TMDS Clock+
13	TMDS Clock Shield
14	TMDS Clock-
15	CEC
16	DDC/CEC Ground
17	SCL
18	SDA
19	+5V Power

Notes:

- Material Specification:
  - 1-1.Housing: LCP+30% G.F UL94 V-0.
  - 1-2.Contact: Copper Alloy (C5191) T=0.15mm.
  - 1-3.Shell: Stainless Steel (SUS304) T=0.30mm.
- Plating Specification:
  - 2-1.Contact: see P/N.
  - 2-2.Shell: Nickel Plated.
- Mechanical Performance:
  - 3-1.Insertion force: 44.1N (4.5kgf) max.
  - 3-2.Withdrawal force: 4.9N~25N (0.5~2.5kgf).
  - 3-3.Durability: 5,000 cycles.
- Electrical Performance:
  - 4-1.Current Rating: 0.3A.
  - 4-2.LLCR: Contact: 30 mΩ max.(initial), Shell: 50 mΩ max.(initial).
  - 4-3.Insulation Resistance:
    - Unmated:100 MΩ min. at 500V DC, Mated:10 MΩ min. at 150V DC.
  - 4-4.Dielectric withstand voltage:
    - 150V AC/60s (mated), 250V AC/60s(unmated).
- IR Reflow:
  - The peak temperature on board shall be maintained for 10 seconds at 260±5°C.
- Operating temperature range: -35°C~105°C.
- RoHS and Reach compliant.

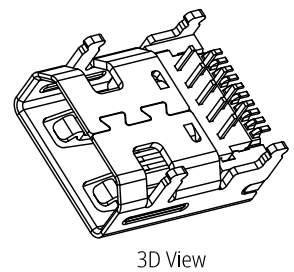

3D View

Part Number: PHD121XX1001  
 Shell Plating Spec. Code:  
 0: Nickel Plated. 1: Gold Flash.  
 Contact Plating Spec. Code:  
 A: Gold Flash on Contact area, matte Tin 60µ" min. on Tails, and 50 µ" min. Nickel overall.  
 B: Au 5µ" on Contact area, matte Tin 60µ" min. on Tails and 50 µ" min. Nickel overall.  
 C: Au 15µ" on Contact area, matte Tin 60µ" min. on Tails, and 50 µ" min. Nickel overall.  
 1: Gold Flash on Contact area, and on Tails. and 50 µ" min.Nickel overall.

THIS DRAWING AND SPECIFICATION ARE THE PROPERTY OF Prolanv AND SHALL NOT BE COPIED OR USED WITHOUT Prolanv PERMISSION

GENERAL TOLERANCES UNLESS SPECIFIED		PART NO.	<b>Prolanv®</b>
PHD121XX1001		TITLE	
X ± 0.30	X° ± 3°	APPROVED BY	Micro HDMI (D Type) 19Pin Rec. 0.4Pitch, Top-Mount CH/1.5, Hybrid Type
XX ± 0.20	X° ± 2°	Kysin	DWG NO.
XXX ± 0.05	XX° ± 1°	CHECKED BY	PHD12-11
CUSTOMER DRAWING		Harry	
SIZE	UNITS	DRAWN BY	
A4	mm[only]	Lucie	
		SHEET	SCALE
		1 / 2	1:1
		REV	B1

1 2 3 4 5 6 7 8

F

F

E

E

D

D

C

C

B

B

A

A

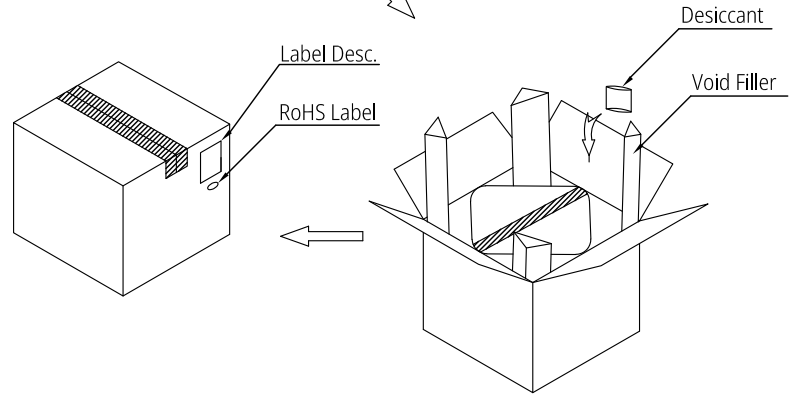
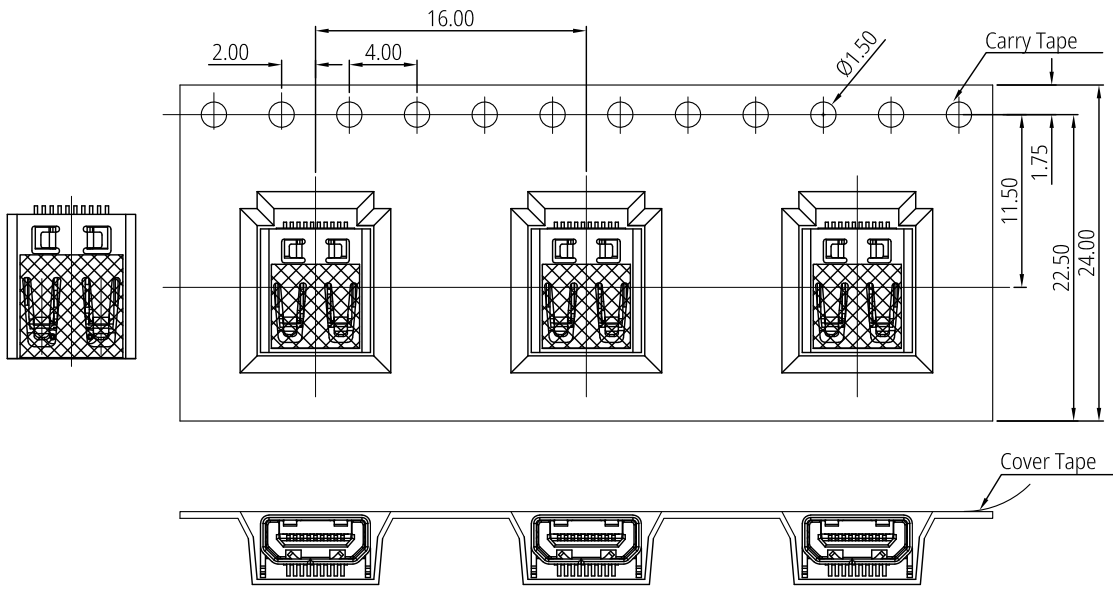
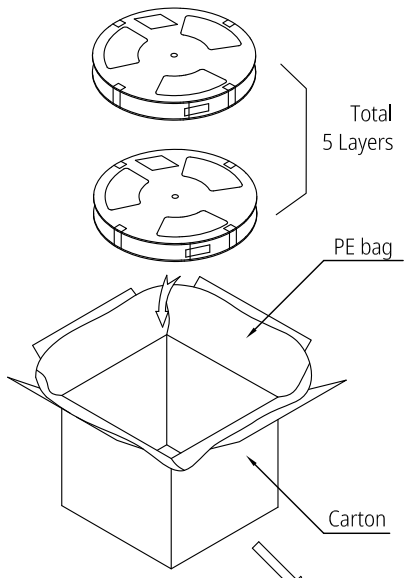
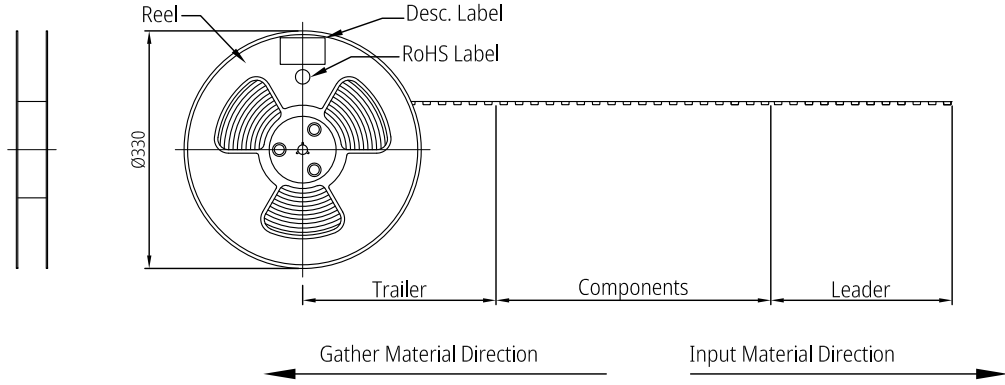

Notes:

- 1.The start and end of each reel, based on the actual quantity, reserved 10~20 pcs space,
- 2.Cover tape and carry tape peel: 10gf~130gf, Peel Deg.:165°~175°, Peel speed: 250~300mm/min.,
- 3.Carton size: 350\*350\*155mm. K=K,
- 4.Q'ty: 1,000 pcs/reel, 5 reels/carton, Total 5,000 pcs/Carton.

THIS DRAWING AND SPECIFICATION ARE THE PROPERTY OF Prolanv AND SHALL NOT BE COPIED OR USED WITHOUT Prolanv PERMISSION	GENERAL TOLERANCES UNLESS SPECIFIED		PART NO.		<b>Prolanv®</b>		
			PHD121XX1001				
	X ± 0.30	X° ± 3°	APPROVED BY		TITLE Micro HDMI (D Type) 19Pin Rec. 0.4Pitch, Top-Mount CH/1.5, Packaging		
	.XX ± 0.20	.X° ± 2°	Kysin				
	.XXX ± 0.05	.XX° ± 1°	CHECKED BY		DWG NO. P-PHD12-11		
CUSTOMER DRAWING		Harry					
SIZE	UNITS	DRAWN BY			SHEET	SCALE	REV
A4	mm[only]	Lucie					

1 2 3 4 5 6 7 8